

DCII

Dry Contact Input Interface

Date: _____

Quantity: _____

Company: _____

Project: _____



The **Dry Contact Input Interface (DCII)** is designed to deliver an enhanced occupant experience by enabling integration between Encelium X Lighting Control System and third-party systems. These systems can include room booking systems in offices, AV in lecture halls, or bedside controls in hospital patient care rooms. Based on the dry contact signal, the Encelium system sets lighting scenes that can include intensity or color temperature. The DCII can also use momentary hold signals to enable raise/lower functionality.

Works with

- Encelium X
 - ▶ GreenBus Wired



Key Features & Benefits

- Provides 6 separate dry contact inputs
- Receive single event signal to turn on, turn off, recall a scene, change color temperature, or change shade position
- Receive momentary hold to raise/lower lighting intensity, color temperature (CCT), or set shade position
- Push-in terminal blocks enable quick wiring and installation

Specifications

SENSING AND CONTROL

Sensing

- Senses dry contact signals from third-party systems to trigger a change of state

Control

- GreenBus Communication
- Wireless Communication (via tethering)

Control Options

- 6 separate dry contact inputs

ELECTRICAL

Supply Voltage

- 12-24V from GreenBus

Maximum Current

- 5 mA

ENVIRONMENTAL

Operating Temperature

- 0° to 40°C (32° to 104°F)

Relative Humidity

- 0% to 95% non-condensing, for indoor use only

PHYSICAL

Dimensions (H x W x D)

- 23 x 98.2 x 53 mm (0.9 x 3.86 x 2.1 inches)

Weight

- 30 g (1.1 oz)

Housing Color

- Black

Housing Material

- ABS plastic

Mounting Options

- Screw Mount
- Adhesive Mount
- DIN Rail Clip Mount

WARRANTY

- For warranty details, refer to full warranty documentation at encelium.com

CERTIFICATIONS & SAFETY

Approbations

- UL Listed (UL 916)
- Plenum Rated (UL 2043)
- FCC Part 15 Subpart B, ICES003



GreenBus[®]

Dimensions

DCII

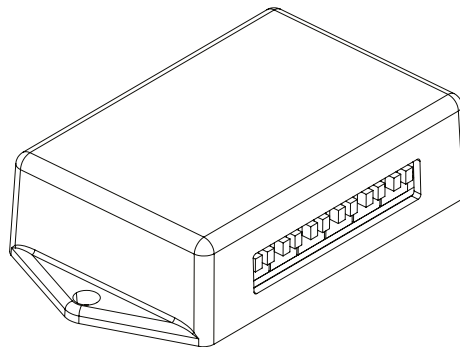
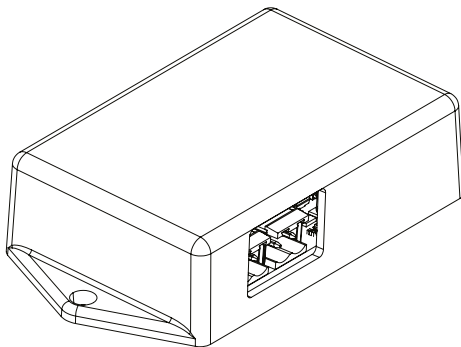
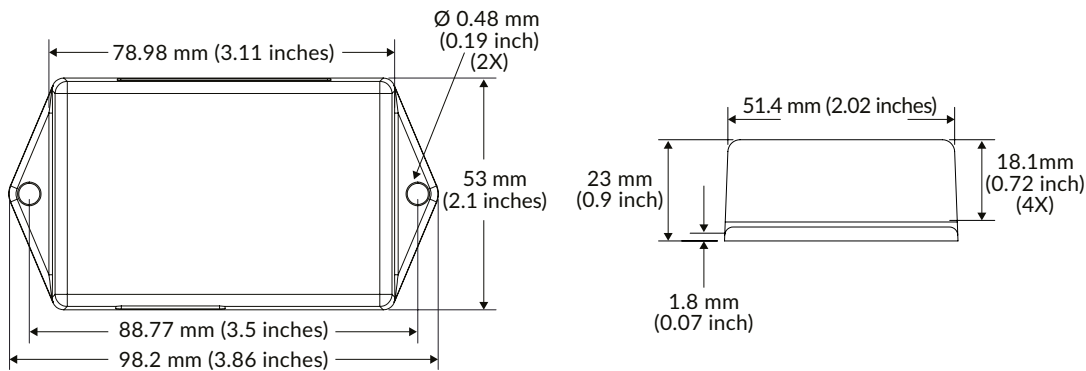

Dimensions (cont.)

Clip Mount

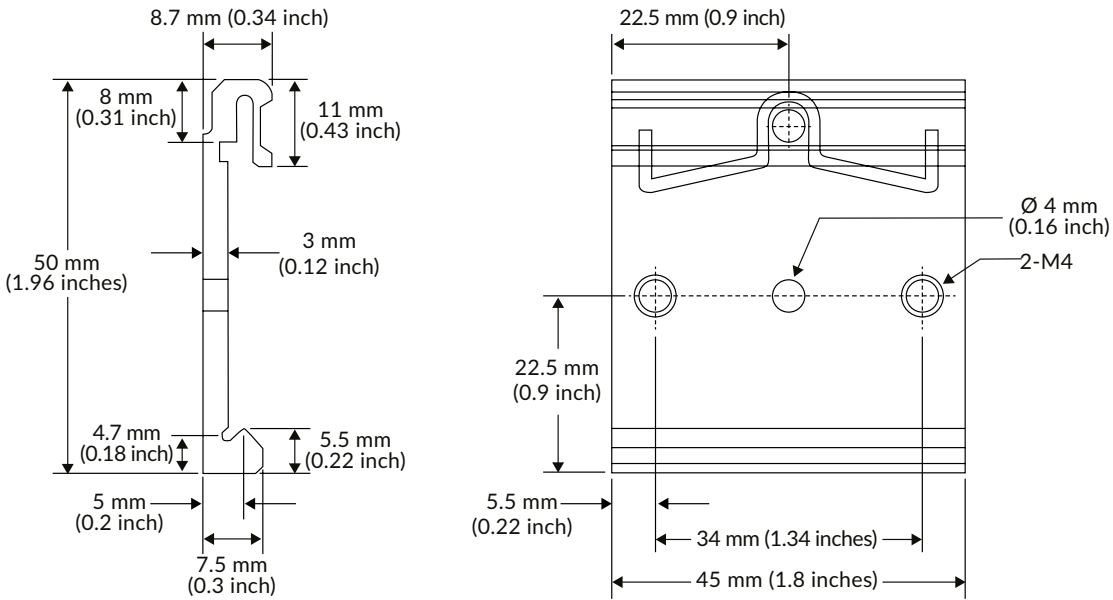

Ordering Information

Catalog Number	Description	Approbation	Communication Network
EN-DCII-GB2	Dry Contact Input Interface*	UL	GreenBus

* Clip Mount are included with the DCII.

Wired System Overview

The DCII is a GreenBus device and is wired using the 2-wire input/output cables in a daisy chain wiring scheme. It can be located in a ceiling or in AV closets depending on the application.

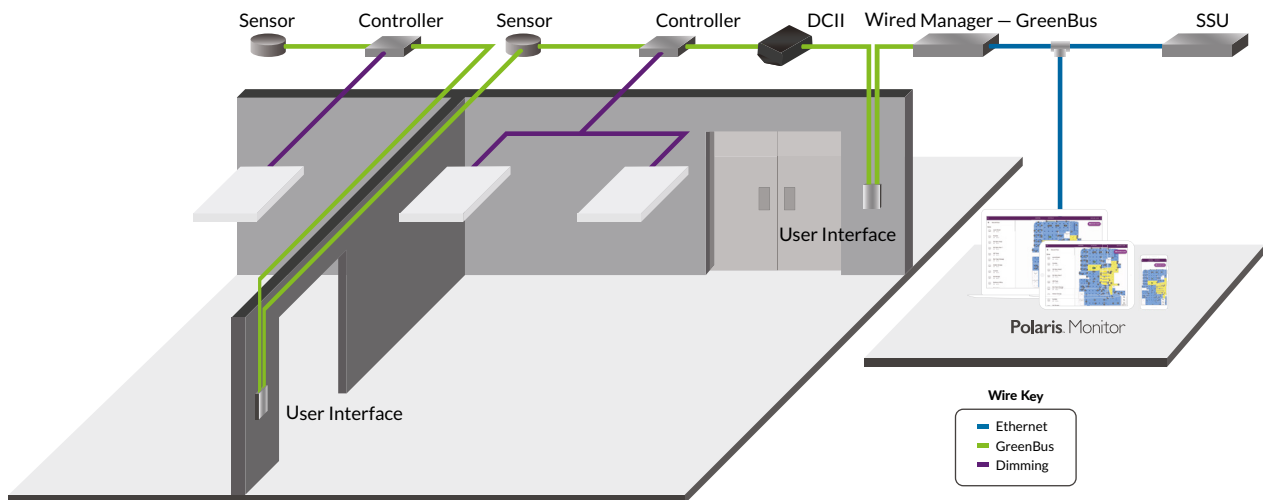

Wireless System Overview

In a wireless system, the DCII is tethered from the GreenBus ports on the load controllers (WCM or WALC).

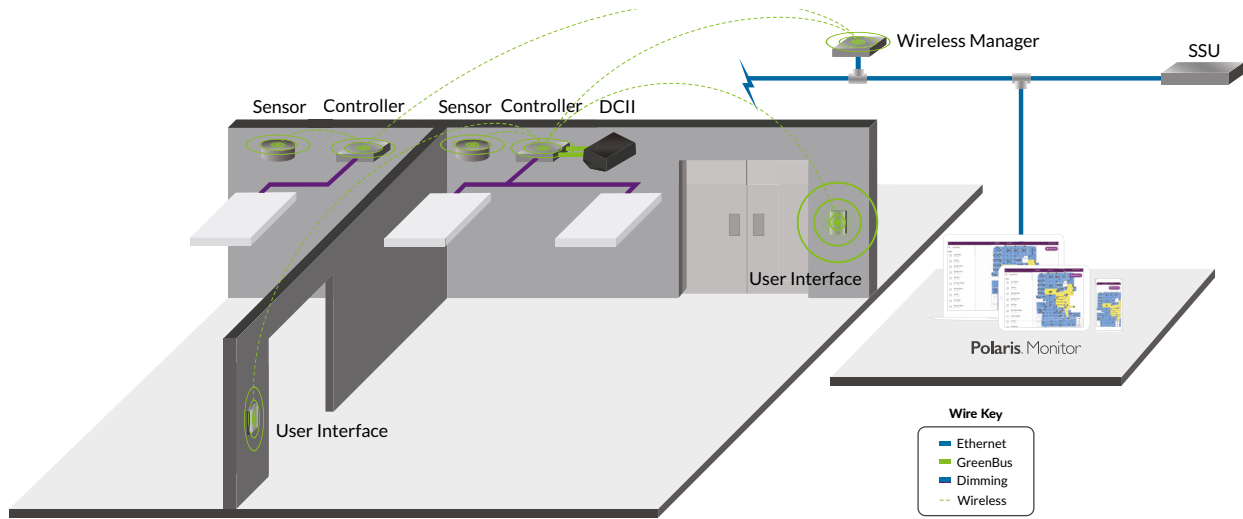

Wiring Diagrams

GreenBus Wiring Diagram

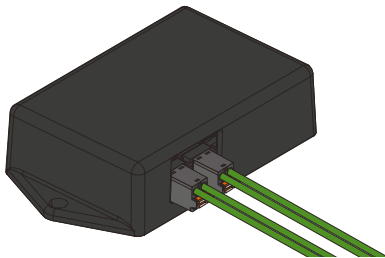

DCII to Third-Party Wiring Diagram

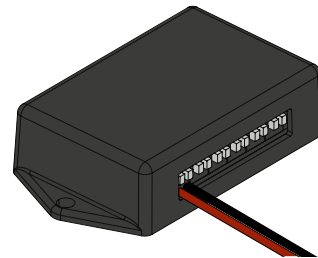

Mounting Options

Screw Mount

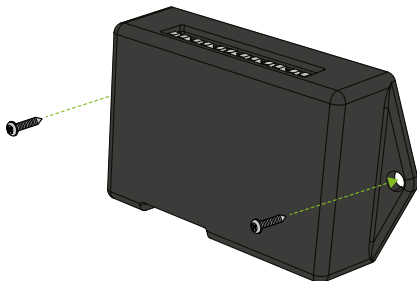

Adhesive Mount

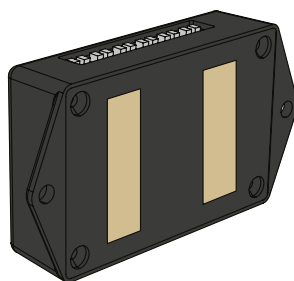

DIN Rail Clip Mount

