

LCM

Wired Luminaire Control Module

Date: _____

Quantity: _____

Company: _____

Project: _____



The Wired **Luminaire Control Module (LCM)** is a 0-10V luminaire level load controller with an internal relay capable of switching AC loads. Similar to other GreenBus devices, the LCM receives power and communication from the Wired Manager. The device is configured to meet the lighting control strategies using Encelium X.

Works with

- Encelium X
 - ▶ GreenBus Wired



Key Features & Benefits

- Self-contained relay switches AC loads
- Single 0-10V dimming line capable of sinking 25mA
- Designed to mount in a standard PG-7 (0.5 inch) trade-size knockout in luminaires or junction box
- Adjusts light levels to respond to variable lighting requirements
- Enables scheduling luminaire group operation to lower energy use during off-peak occupancy
- Customizing lighting scenes for tailored experiences/tasks

Specifications

SENSING AND CONTROL

Control

- GreenBus Communication

Control Outputs

- Single 0-10V dimming output (IEC 60929 Annex E). Capable of sinking 25mA (this is equivalent to 25 typical dimming ballasts/LED drivers)¹

ELECTRICAL

Absolute Maximum Ratings²

- 4.5A, 120 to 480 VAC – Ballast/LED Driver
- 4.5A, 120 to 480 VAC – Resistive
- 4.5A, 120 to 480 VAC – Tungsten
- 4.5A, 120 to 480 VAC – General Purpose

Connections

- Black: Line In/Out, Relay Contact
- Black: Line In/Out, Relay Contact
- Purple: 0-10V +
- Pink: 0-10V -

ENVIRONMENTAL

Operating Temperature

- -40° to 55°C (-40° to 131°F)

PHYSICAL

Dimensions (H x W x D)

- 25.6 x 60.7 x 30 mm (1 x 2.38 x 1.18 inches)

Weight

- 65 g (2.3 oz)

Housing Color

- Black

Housing Material

- ABS Plastic

Mounting Options

- Luminaire Mount
- Junction Box Mount (Standard PG-7 (0.5 inch) trade-size knockout)

Wire Gauges

- 305 mm (12 inches), Black Wires
- 914.4 mm (36 inches), Purple and Pink Wires

WARRANTY

- For warranty details, refer to the full warranty documentation at encelium.com

CERTIFICATIONS & SAFETY

Approbations

- UL916 cUL US Listed (Energy Management Equipment)
- UL924 cUL US Listed (Emergency Lighting Equipment)
- UL2043 Plenum Rated
- FCC Part 15/ICES-003
- RoHS Compliant

Complies with Electromagnetic Compatibility

(EMC) Standards:

- EN 61000-4-2
- EN 61000-4-4
- EN 61000-4-5



GreenBus™

Dimensions

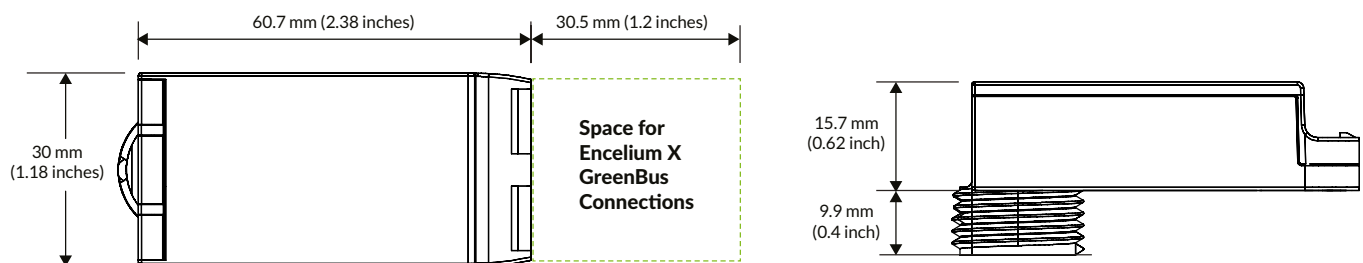

Footnotes:

¹ Maximum wire length: 30 m (100 ft), Class 2 only.

² Maximum of 2 luminaires.

Ordering Information

Catalog Number	Description	Approbation	Communication Network	Modifiers
EN-ILCM-1R10V-GB2-BK	Luminaire Control Module	UL	GreenBus	Black Housing (BK)
EN-LCM-1R10V-GB2BKDR	Luminaire Control Module	UL	GreenBus	Black Housing/Damp Rated (BK/DR)

Wired System Overview

GreenBus technology makes wiring fast and error-free, since it's intuitive to install. With Encelium X, you can control DALI devices exclusively or a mixture of GreenBus and DALI.

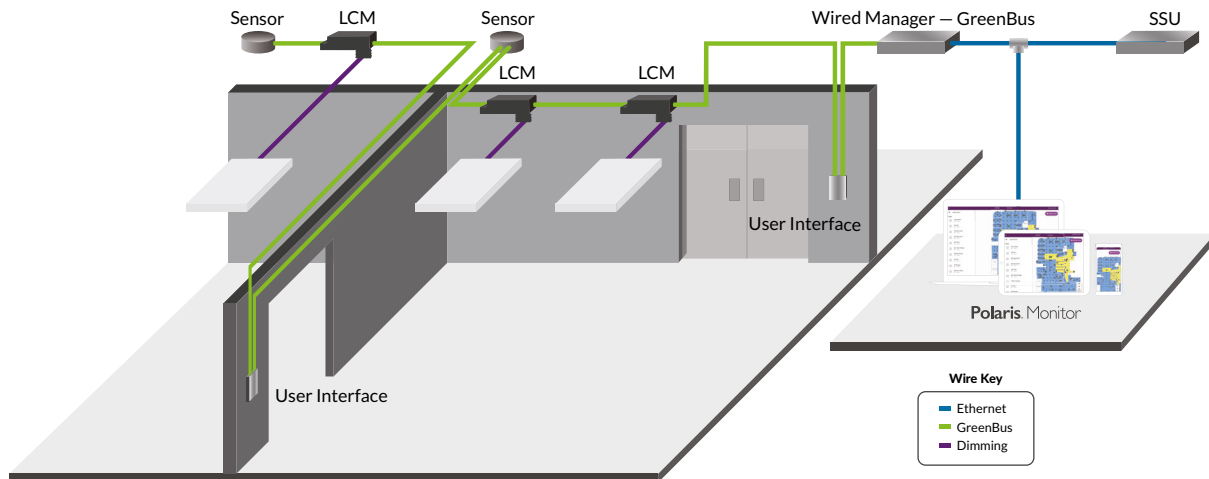

Wiring Diagrams

LCM Wiring

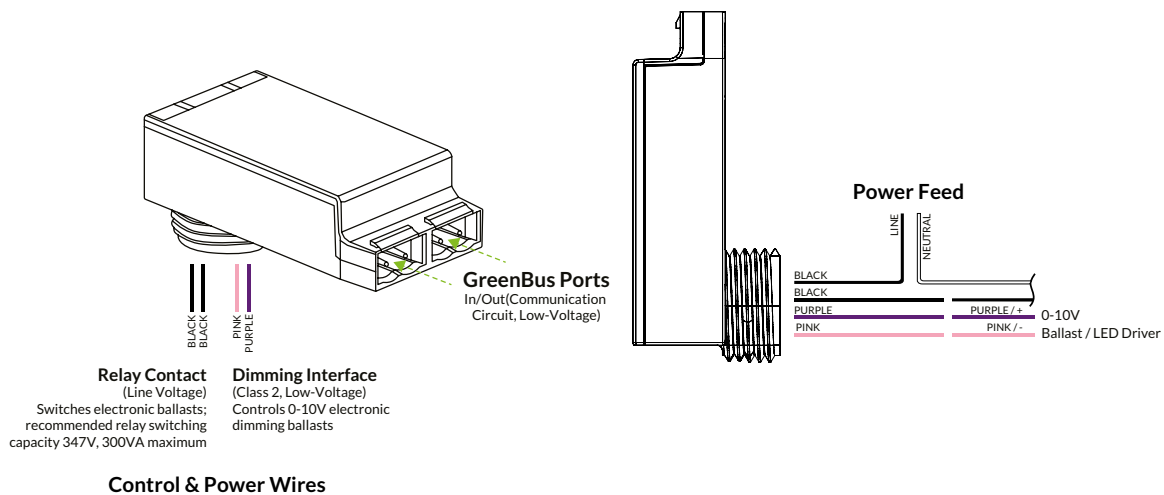

Wiring Diagrams (cont.)

Dimmable Luminaire Wiring

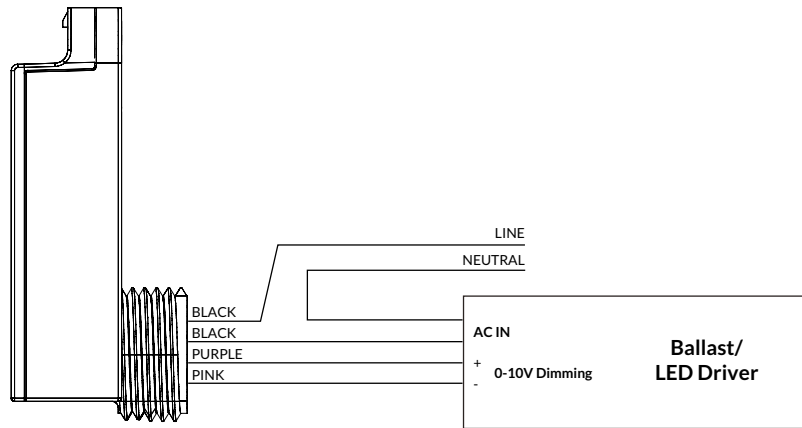

Junction Box Wiring

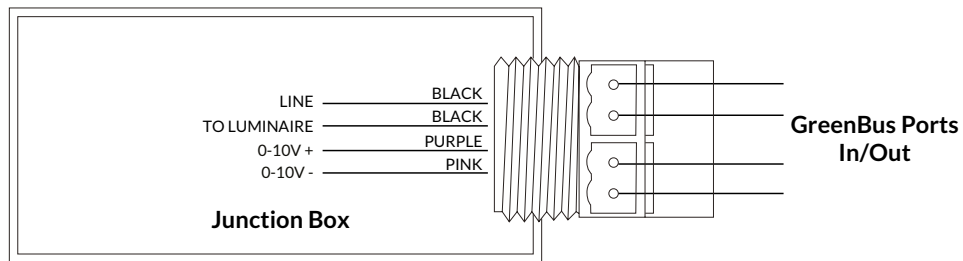

Mounting Options

The mechanical construction allows for simple installation of the LCM to an available PG-7 (0.5 inch) trade-size knockout on the side or on top of a luminaire. GreenBus communication wiring is still accessible from the outside of the luminaire, while all necessary wiring to the electronic dimming ballast/LED driver is available on the inside.

For some installations, a junction box may be required. It is recommended to securely mount the LCM to the junction box using an available PG-7 (0.5 inch) trade-size knockout.

Luminaire Mount

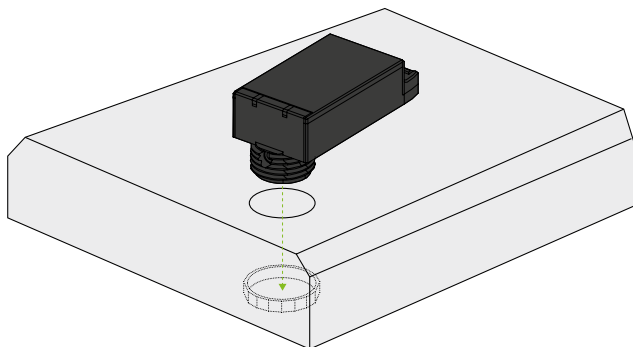

Junction Box Mount

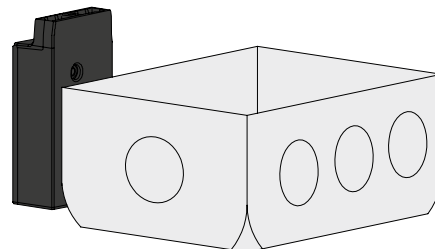

Installation Testing

Installer can quickly test if the devices have been wired correctly by pressing any button on the wallstation or the sensor which triggers all the load controllers on the channel to change the dimming level by 25%. Every press will trigger this function to enable testing of the AC line wiring, dimming wiring, and communication integrity over the GreenBus lines.

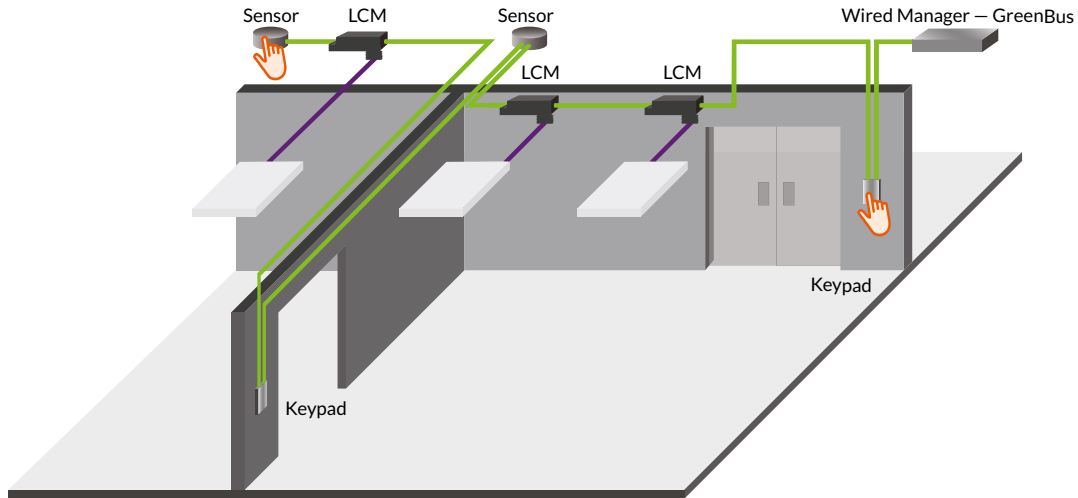

Manual Pairing

Installers can easily pair devices in a room or a zone to gain manual control (on, off and dimming) and occupancy time outs. Holding any buttons on a wallstation or sensor for 10 seconds enters the system in the Manual Pairing mode. The system then guides the user by blinking the load controllers on the GreenBus wiring scheme as a means of identifying and pairing them to the wallstation or sensor.

